

**CLEARWATER**  
900 SQ. FT.

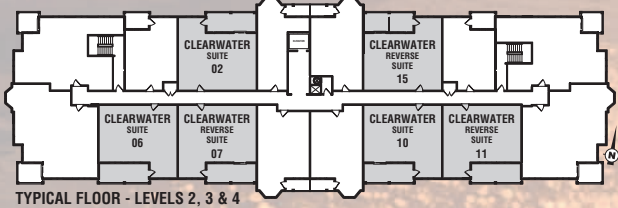
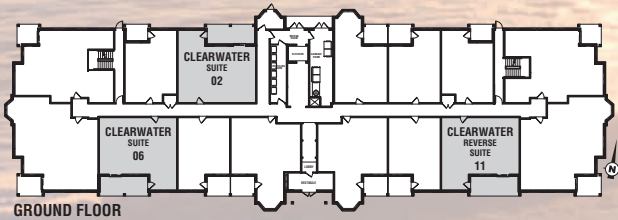

**MARINA VILLA**  
AT THE PORT OF NEWCASTLE

**KAITLIN GROUP**  
BUILDING EXCELLENCE

Some Ground Floor patios may require railings as per grading conditions.

Materials, specifications, and floorplans are subject to change without notice. All renderings are artist's conceptions. All floorplans are approximate dimensions. Actual usable floor space may vary from stated floor area. E. & O. E. SEPT./06